



# Cyclepods

Transforming bike storage

YOUR PARTNER FOR ALL THINGS CYCLING RELATED



## CYCLEPODS IN LOCAL AUTHORITIES

WWW.CYCLEPODS.CO.UK - T:0845 094 0490 - F:0845 094 0151 - INFO@CYCLEPODS.CO.UK

With demands for cycle provisions growing, more and more councils and local authorities are looking to provide real solutions and facilities to encourage cycling and sustainable travel. Cyclepods have worked with Local Authorities all over the United Kingdom for the past 10 years and have installed cycle parking and cycling infrastructure tools across numerous schools, stations, high streets, leisure centres, parks, shopping centres and workplaces. Now offering not only cycle parking solutions but several infrastructure tools and facilities for the public realm, Cyclepods have recently developed their own access technology for cycle hubs that can be easily configurable to work with any smart travelcards or leisure passes.

## CYCLE PARKING SOLUTIONS

### STREETPODS

Our Streetpod was specifically designed to give maximum security bike storage in public spaces. We wanted to design a product for non-secure environments such as inner-city, low-footfall railway stations, high streets or public spaces that would only require one lock to secure the whole bike, making it as convenient as possible for the everyday user. Each unit also has the optional fitting for advertising space. This not only provides an opportunity to offset the cost of purchasing the Streetpods but also offers Local Authorities the chance of generating additional revenue!



## LEWISHAM HIGH STREET

In 2014 Lewisham Borough Council purchased around 200 Sheffield Stands and 32 Streetpods for placing at different locations around the borough. The locations of the Sheffield stands were mainly for public use on high streets, but also for workplaces and residential streets and estates.

The remaining 24 Streetpods were situated along Lewisham High Street next to Lewisham Shopping Centre, this provides 48 secured bike parking spaces for visitors to the shopping centres or Lewisham Market as well as for shop staff and bike deliveries!

2 years later, we went back to see how the Streetpods were getting on and had a chat with a few local cyclists that used the pods. The convenient locations and security of the Streetpods made them a far more attractive solution for longer term parking than the traditional hoop stands that were available.

We also observed that there were bikes locked into the hoop stands that had been severely vandalised, all these bikes were either missing wheels or the owners had removed a wheel to prevent it being stolen. With a Streetpod, the front wheel is completely protected within the MDPE casing so the quick release cannot be accessed, meaning it cannot be stolen and there is no need to remove a wheel and lug it around with you to keep your bike safe!

As well as its secure design, the Streetpod holds 2 bikes per unit in 30% less space than a traditional bike rack making it space-saving as well.

The Streetpod went through a rigorous independent testing process to achieve Secured by Design status, it is also Sold Secure Silver and the only Police-Approved bike storage solution!





## **LONDON BOROUGH OF REDBRIDGE**

For the 2012 London Olympics, LB of Redbridge installed 100 Streetpods in total at Seven Kings Car Park & Gants Hill Car Park, both sets of Streetpods were customised with coloured back panels matching the Olympic rings. As part of the London 2012 Olympic Legacy, LB Redbridge uninstalled 81 of these Streetpods from the two original car parks and re-installed them across 33 locations, including high streets, schools, parks, recreation grounds, car parks & community centres, across the borough!

*"I thought they looked very effective, especially so as deterrent against theft, which as we know is a major deterrent against cycling" - Gill James | LCC Redbridge*

## **BLACKPOOL SPORTS CENTRE**

At Blackpool Sports Centre we installed Streetpods in order to fight a bike crime issue that the sports centre was experiencing. At that time an average of 6 bikes were stolen from outside the Sports Centre every month! Since installing the Streetpods, the number of bike thefts has dropped dramatically from 6 per month to 6 thefts in 18 months.

The British Transport Police asked us to undertake additional testing to satisfy them with graffiti and fire resistance. We were able to demonstrate that graffiti can be washed off with fairy liquid in warm water and a kitchen sponge and that lighting a fire in the Streetpod using newspaper will burn without any damage to the Streetpod.

## BIKE HANGAR

The Cyclepods Bike Hangar is the perfect answer for community cycle parking. De-clutter the streets and residences with this robust and secure design.

The Cyclepods Bike Hangar is an increasingly popular design for outdoor cycle parking on residential streets & housing estates. Galvanized mild steel construction with a gas sprung door and perforated side panels offer a safe and effective way to protect bikes from tough weather conditions and vandalism. Each Bike Hangar stores up to six bicycles and only occupies half a parking space. The lock and the handle are positioned at a comfortable height of 35 inches. The door is pushed upwards by two gas springs and will stay open at any desired height. Children aged 9 or 10 years and up can operate the Bike Hangar on their own.

A “Dutch” style high low rack is secured within the unit to store 5 or 6 bikes, without causing damage to the cyclist's bike.

## CYCLEPODS BIKE HANGAR RENTAL SCHEME

Cyclepods also run a dedicated website through which Councils can manage the bike hangars in their boroughs. Using the online programme, residents of your borough or local authority can find their nearest bike hangars and hire a space at a price set by you. Each LA that purchases a bike hangar for public use receives their own individual domain name and page customised to your requirements.



# CYCLE STAND DESIGNS

We offer a large range of cycle stand designs from the simple to the stylish.

This means that no matter what shape or size you are looking for, we can provide it.

There is also an option to work with our in-house design team and create a bespoke design. This isn't as costly as most people think!

Specification:

Finish:

Galvanised finish as standard.

Stainless steel, Rilsan coated and powder coating available on all stands.

Installation Options:

Root fix or bolt down surface mount available on all stands.

**SHEFFIELD STAND**



**LONDON STAND**



**T-LOVE STAND**



**M HOOP STAND**



**SAFE-T-PIN STAND**



**LOLLIPOP STAND**



# CYCLE STAND DESIGNS

## WHICH STAND DO I CHOOSE?

The different designs allow the stand to be chosen to fit the environment.

Stands with tapping bars such as the London stand and the Theta stand allow for more security and prohibit locks being manouevured to the ground to be broken.

Multiple locking points on stands such as the M Hoop stand, Tulip stand and Hoop post stand allow for the front and rear wheels to be locked seperately.

When space is at a premium such as town centre pavements, the Lollipop and Safe-T-Pin stands are ideal as they take up very little space.

When aesthetics has to be a consideration, the simplicity of a Sheffield stand, O stand or Heavy Hoop stand can be favourable or the elaborate design of the T-Love stand and Big Loop stand can help bring a fresh new look to an area.

O BIKE STAND



HEAVY HOOP STAND



THETA STAND



TULIP STAND



BIG LOOP STAND



HOOP POST STAND



## CANTERBURY SHELTER



## BRIGHTON SHELTER



## WINCHESTER COMPOUND



# CYCLE SHELTER DESIGNS

We have designed a wide range of both single-tier and two tier parking shelters that are robust, stylish and yet functional. Cabling can be run up the legs of the shelters thus avoiding the need for unsightly trunking. Some of our shelter roofs are designed in such a way that algae, tree sap or rubbish can't be seen from below and thus avoiding service quality fails or high level maintenance. Sheltered bike racks can be securely enclosed with fencing and lockable gates.

These are our most popular shelters, but we offer a wide range and can create bespoke items.

## CYCLE HUBS

Our Cycle Hubs are the cutting edge in high volume bike storage facilities. Cycle Hubs are for cyclists, and so need to be cyclist friendly. This means a Hub needs to be more than a bike storage space, it should be a fully equipped facility.

There is no such thing as an off the shelf “hub” and what is a “hub” anyway? Every hub has to be carefully designed to fit bespoke requirements and needs, so there is no such thing as a generic cycle hub. We have created and designed solutions for Hub buildings as well as a range of technology based systems, which we call ‘Cycology’, to equip your hub with. This gives you the ability to customise your hub by picking and choosing using the individual components that suit you and your cyclists best.

When building a Cycle Hub, we believe that it should contain all the facilities that the everyday cyclist may need to ensure that the Hub provides a self-sustainable and user-friendly environment for cyclists. You can boost the security of the Cycle Hub and make cyclists feel safer in using it by adding a CCTV system and access control. And little touches like a Bike Repair Stand & Pump or Lighting can transform a bunch of bike racks into a valued piece of cycling infrastructure.

*Lewes Cycle Hub,  
Heathrow Cycle Hub,  
Horsham Cycle Station  
and Woking Cycle Hub*



## LEYTON CYCLE SUPER HUB

As part of LB Waltham Forest's Mini-Holland Scheme, Cyclepods have designed and are constructing the two storey Cycle Super Hub in Leyton High Street. Based on our Lewes Cycle Hub, the design will complement the modern architecture within the area, as well as stand out in its own right as a purposeful, innovative and desirable building. The use of transparent material as cladding will ensure the building is "see through" and appear smaller than its physical dimensions suggest.

The high street location demands a large hub to accommodate the potential footfall from the station, shopping and local cyclist traffic. The natural street levels actually work in favour of a double level hub as access to the upper level can be achieved from the street. We have therefore produced our design in line with this; access from the street to the upper deck and access to the lower level via stairs with the aid of a cycle ramp. Due to the modular nature of our design, the lower level could be easily extended, if usage needs demand it.

Access Controlled doors will be installed on both the top and bottom floor entrances with a Paxton 2 entry system. The building will be well lit using standard fluorescent, vandal proof and IP 65 rated tubes to ensure all areas within the hub are not cast in shadow and well lit.

CCTV will be included in the Hub for security, due to the very public location and the high levels of traffic expected through the Hub. We will also be putting in the only Secured By Design glass sliding door system in the country which will make the hub extremely secure and protected, the design of the building itself, based on our Lewes Cycle Hub, is also National Building Accredited.

A Bike Pump & Repair Stand will be available on both floors as well as a Help Point for users. The top floor will contain Easylift+ Two-Tier storage for maximum capacity, with the lower level containing Streetpods for Secured By Design approved storage.



# CYCLING INFRASTRUCTURE TOOLS

## CYCOLOGY

Our “Cycology range” is a fusion of cycle facilities using the latest technology, from bicycle counters to cycle access control, bike hire systems to bike detection and tools for implementing safer cycling infrastructure.

## CYCLE COUNTERS

### MEASURE & RECORD

The Cyclepods engineered radar system is a cost-effective and accurate solution for measuring traffic count, vehicle type and speed behaviour

The Easy Radar Cycle counter is an above ground traffic and bicycle monitoring system designed to meet the needs of Highways Agencies, Local Authorities and Police through to Public Amenity Sites, Parish Councils and Private Businesses. Unobtrusive and discreet, it provides count, speed and classification data without the need for costly in-road installations or road damaging and potentially dangerous pneumatic tube counters.

- No in-road equipment
- No pneumatic tubes
- Real-time classification
- Safe & easy to deploy
- Permanent & temporary applications
- Optional remote monitoring
- Solar-powered option

### VERSATILE

With an integrated GSM/GPRS or 3G modem for streaming data to a back office computer, server or cloud based data storage system and Bluetooth interface for local interrogation, the Easy Radar system is designed to meet the requirements of both permanent and temporary applications. It can be set up for Real-time Vehicle by Vehicle (VBV) surveys, Real-time binned surveys, historic VBV surveys and historic Binned surveys. Vehicle by Vehicle (VBV data collection) allows for the following fields to be collected: ‘Count’, Speed, Length ‘headway’ and ‘gap’. From this data statistical analysis can be carried out offering councils the empirical evidence needed to make a powerful case for change.



## RE-FLEX CYCLE LANE POSTS

The Re-Flex cycle lane post helps to prevent collisions with posts and bollards placed on cycle lanes. The posts are easy to see and flexible, making them by far the best solution on cycle lanes and cycle paths. They have LED lighting and high-reflectivity strips and are exactly the right height and width. All this means that cyclists are much less likely to collide with them. However, if a cyclist does collide with the Re-Flex post, it is not rigid and has some built-in 'give'; the flexible material will also bend, helping to prevent injuries. Although the Re-Flex is flexible - it has a steel core that makes sure that cars are kept well away! The Re-Flex has been awarded a Good Industrial Design Award. In order to qualify for the award, a product has to be more than just beautiful; functionality, innovation and materials are equally important. The jury found that the Re-Flex met all these criteria.

## STOWING THE POST

The post can easily be unlocked and stowed in the Drop-Box storage element. It takes just a couple of seconds to stow each post below ground level. Once stowed, there is no obstacle at all on the road surface. The cover of the Drop-Box is made of stainless steel checker plate to prevent the risk of slipping.

## ADVANTAGES

- Forgiving and flexible, helping to prevent cycling accidents
- Stands out, because it is the right colour, has a reflective surface and is the right height and width
- Will bend, minimizing the chance of injury
- The model with built-in LED lighting provides even more visibility
- Easy to install using an (existing) VelopA concrete base
- Fully recyclable



## REPAIR STANDS & BIKE PUMPS

Cycle Repair Stands and Pumps keep your cyclists on the go by providing easy-to-use tools for basic bike repairs. From our popular full-featured Fix-it stand which includes the wrenches, screwdrivers, and air pump needed for basic bike maintenance, to the stand-alone Air Kit pump add-on for bike racks.

Air Kit 2 and Air Kit 3 bike pumps are our most robust public pumps designed for heavy duty use day in, day out. Both pumps fit Schrader and Presta valves which means all cyclists are accommodated for.

The Fix It Repair Stand is designed for public use and includes tools to perform basic repairs from changing a flat tyre to adjusting brakes and derailleurs. The tools are securely attached to the stand with stainless steel cables and tamper-proof fasteners. Hanging the bike from the arms allows the pedals and wheels to spin freely whilst making adjustments. The hanger arms can be mounted at 12, 3, 6 or 9 o'clock and accommodates most types of bikes.

We have installed Bike Pumps & Repair Stands across numerous stations, high street, school & workplace environments.

Bournemouth Council purchased 6 Repair Stands and 6 Air Kit 3 Bike Pumps to place around Bournemouth City centre and at regular intervals across the seafront on their city cycle route. The cycle route is favored by high numbers of cyclists due to the picturesque location so the Air Kit 3 was the best pump for frequent use due to its robust design.

By providing facilities for minor bike repairs, you can provide seamless journey links and create welcome spaces for cyclists. Repair Stands and Pumps are additional features for any cycle parking project that make the difference between 'bike racks' and 'cycle friendly facilities'.



# STREETPOD

The Streetpod is our latest revolutionary cycle storage design! This highly secure and stylish product offers maximum bike protection for public location and open spaces, where bike security is a concern.

It is UK Police recommended and is the **ONLY** cycle parking product to achieve a level 2 "Secure by Design" security rating.

The front wheel is housed within the security shield which prohibits it from being removed.

The Streetpod has the ability to secure the bike frame and both wheels with a single lock. This highly configurable design can also accommodate advertising and sponsorship.



Product Name: Streetpod—SBD

Panel Material: Medium density polyethylene (MDPE), Black version is recycled and recyclable, where as colour versions are just recyclable.

Wall Thickness: 7-9 mm. 65mm channel/ track width to cater for 99% of all standard European tyre width's.

Finish: Dimpled effect. Standard colour black, other colours available at additional cost.

Product Weight: 20kg each.

Securing loop: Galvanised Steel as standard, Stainless steel option available.

Securing loop thickness: 50 mm diameter, with 3.2mm thickness . 20mm solid securing bar.

Fixing Method for loop Arms: Fixed to floor using ground anchors/resin.

Fixings Material: All standard Streetpod fixings are Galvanised/Stainless steel. Ground anchors are nickel plated.

Ground Fixings Required: 3 types: 16mm outer diameter shield anchor bolts drilled to a depth of 100mm max . Self using M14 Sheer off nuts and resin. 5 fixing bolt required per Streetpod

Ground Type Required: Solid level base required. Concrete, large slabs with minimum 50mm thickness  
Internal fixings: Shear off nuts + Loc tight to be used on all internal fixings.

Product Code: STREET001  
Colour Options: Standard in Black (Recyclable) Red, Yellow, Royal Blue, Light Blue, Dark Green, Light Green, Grey, Stone effect and multicolour available.

Various shelter options available for all products.

## STREETPOD SPACE SAVINGS

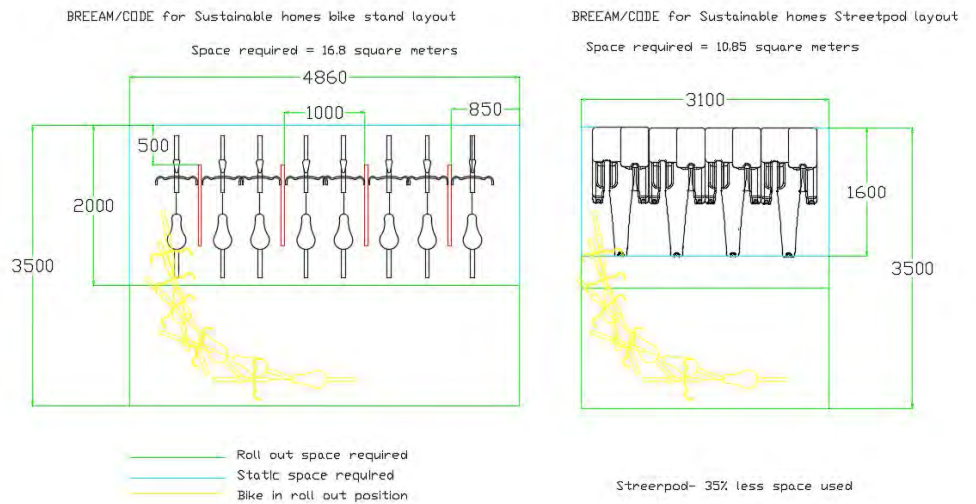

## STREETPOD DIMENSIONS

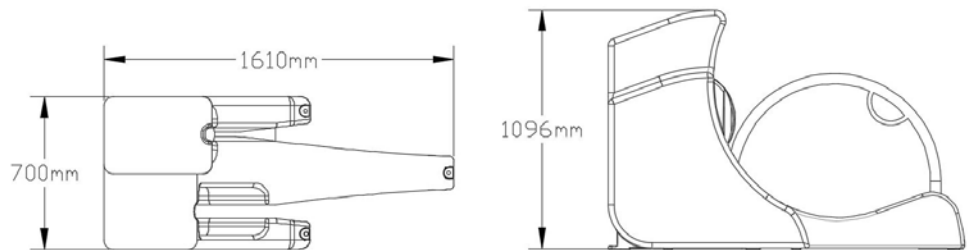

## STREETPOD 3D VIEW

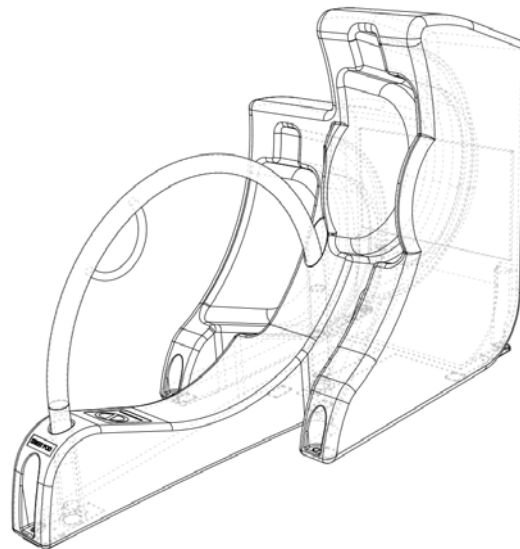

## HOW TO LOCK YOUR BIKE TO THE STREETPOD:

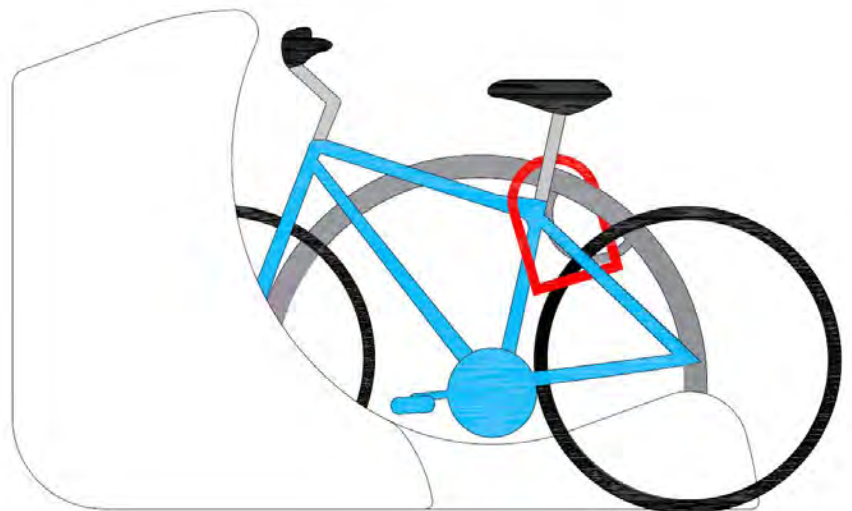

# BIKE HANGAR 6 BIKE VERSION

Product Name:

Cyclepods Bike Hangar - 6 bike

Product Description:

The Cyclepods Bike Hangar is the perfect answer for community cycle parking. De-clutter the streets and residences with this robust and secure design.

Product dimensions:

L 2450mm x D 2000mm x H 1400mm

Specification:

Shelter manufactured from hot dipped

Galvanised steel to BSEN ISO1461

Perforated side panels

Gas sprung door which remains at required height

Protects bikes from vandalism and

adverse weather conditions

Placed in half a parking space

"Dutch" style high low rack is secured within the unit to store 6 bikes

Euro cylinder locks ensure security and master key access

Mechanical keypad lock also available

Adjustable legs

Colours available:

Green.

Frame can be powder coated as an option.

Installation Notes:

Submerged fixing or bolt down

For large quantities, alternative colours are available.



## Cyclepods Bike Hangar Rental Scheme

Cyclepods also run a dedicated website through which Councils can manage the bike hangars in their boroughs. Using the online programme, residents of your borough or local authority can find their nearest bike hangars and hire a space at a price set by you. Each LA that purchases a bike hangar for public use receives their own individual domain name and page customised to your requirements.

# FIETSHANGAR 5 BIKE VERSION

Product Name:

Cyclepods Fietshangar - 5 bike

Product Description:

The Cyclepods Fietshangar is the perfect answer for community cycle parking. De-clutter the streets and residences with this robust and secure design.

Product dimensions:

L 2300mm x D 1800mm x  
H 1500mm

Specification:

Shelter manufactured from hot dipped Galvanised steel to BSEN ISO1461  
Perforated side panels.

Gas sprung door which remains at required height.

Protects bikes from vandalism and adverse weather conditions.

Placed in half a parking space.

"Dutch" style high low rack is secured within the unit to store 5 bikes.

Euro cylinder locks ensure security and master key access.

Adjustable feet.

Colours available:

Green, blue, grey, brown

Installation Notes:

Submerged fixing or bolt down

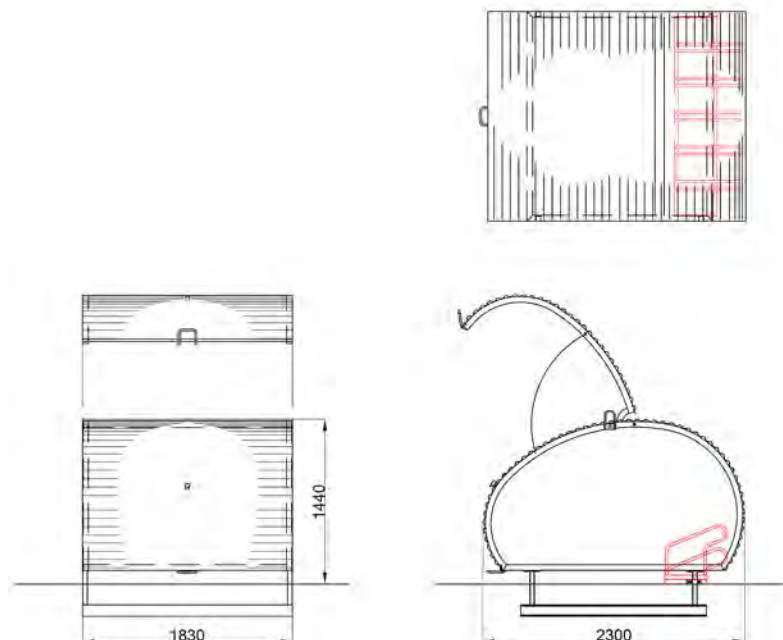

# PUBLIC BIKE REPAIR STAND

The Public Bike Repair Stand is ideal for carrying out basic repairs such as repairing a puncture to adjusting brakes and gears. The tools are securely attached to the stand with stainless steel cables and tamper-proof fasteners. Hanging the bike from the arms allows the pedals and wheels to spin freely whilst making adjustments. It is ideal for train stations, universities and even the high street!

Product dimensions:  
D 500mm x H 1500mm

## Specification:

Main Body: 160x4mm tube

Bike Hanger: 38mm tube

Hand tools:

- Phillips and flat head screwdrivers
- 2.5, 3, 4, 5, 6, 8mm allen keys
- Headset spanner
- Pedal Spanner
- 8, 9, 10, 11mm box spanners

2 steel tyre levers

Tool tethers: 4mm stainless steel cable  
Hot dipped galvanised steel to BS EN ISO1461

Galvanised finish as standard. Powder coating available as an option.

Colours available: Black, white, grey, red, orange, yellow, green, light green (shown), brown, beige, purple.

## Installation Notes:

Bolt down fixing

Pump is NOT included. Please see our range of pumps.



# AIR KIT 3 BIKE PUMP

Help cyclists on their journey with the Cyclepods Air Kit 3 bike pump. Featuring a waterproof pressure gauge, the Air Kit 3 requires only minimal maintenance. Specifically designed for repeated heavy duty use, it is ideal for train stations, universities and even the high street!

The Air Kit 3 fits both Schrader and Presta valves, meaning that all cyclists will be accommodated for.

Product dimensions:  
H 750mm x 150mm diameter

Specification:  
Main Body: 150x4mm tube  
Top: 6mm Polycarbonate  
Foot: 6mm steel  
Hot dipped galvanised steel to BS EN ISO1461  
Oil-filled pressure gauge  
Steel reinforced rubber hose

Galvanised finish as standard. Powder coating available as an option.  
Colours available: Black, white, grey, red, orange, yellow, green, light green (shown), brown, beige, purple.

Installation Notes:  
Bolt down fixing

For large quantities, alternative colours are available.



# TESTIMONIALS

*"The Streetpods seem to have been a great success, and much better used than the standard Sheffield racks that they replaced. D-locks are being left on them, which is a good indicator that they are being used regularly by the same people."*

**CHRIS ELLIOTT | LONDON CYCLING CAMPAIGN**

---

*"The Streetpods, with their innovative single locking feature and advertising panels seemed like the obvious choice to remedy the issue of fly-parking at the busy Peterborough Bus Station. As anticipated they were being used within an hour of them being installed."*

**MATTHEW BARBER | PETERBOROUGH COUNCIL**

---

*"The pods are used regularly by both male and female cyclists who always speak positively about their function. They also provide a great visual message about sustainable travel within our organisation and are regular talking point amount the local community."*

**FIONA DALY, ENVIRONMENTAL MANAGER | ST BART'S AND THE LONDON HOSPITAL**

---

**CYCLEPODS LTD  
2 BETSOMS BARN  
PILGRIMS WAY  
WESTERHAM  
KENT  
TN16 2DS**